

VIEWING

TYPE	A	B
LED B/L	12.5	7.9

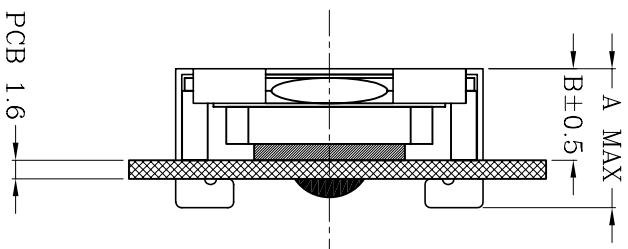
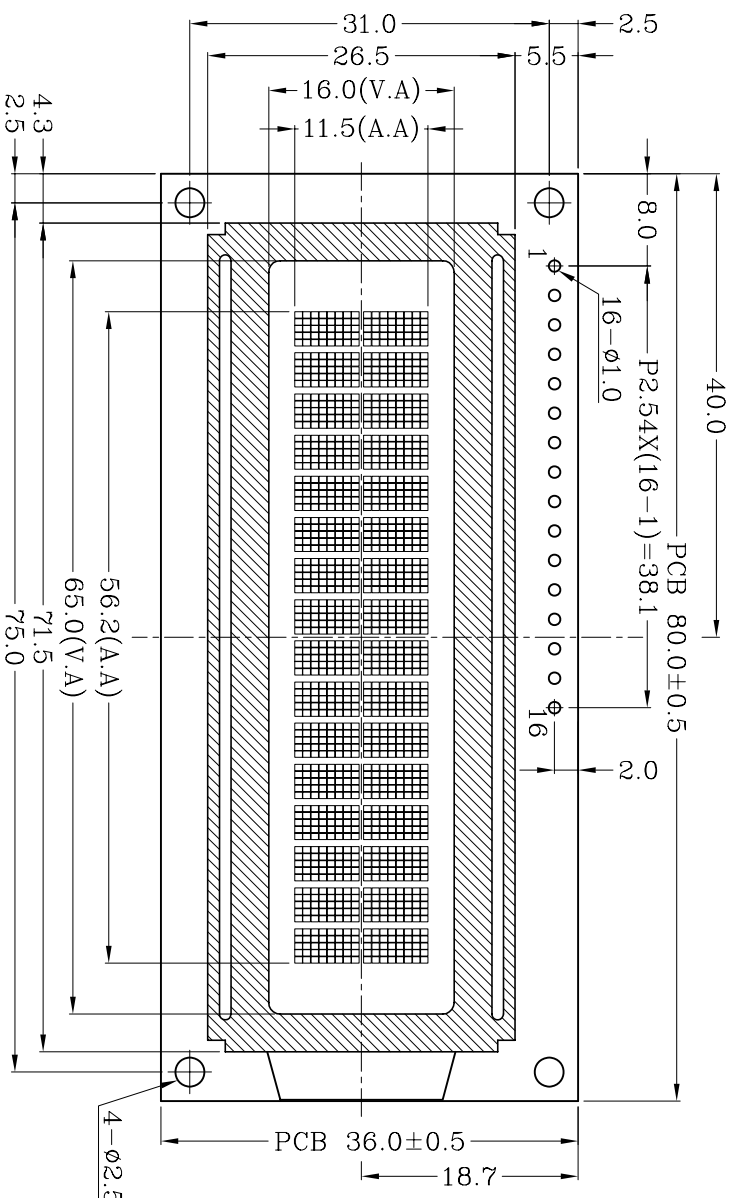
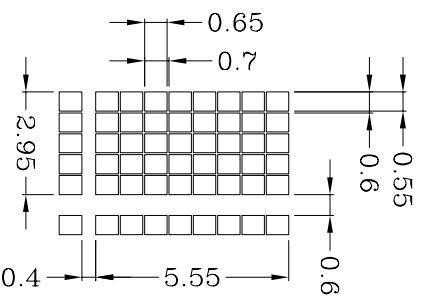

DETAIL DOTS
 SCALE: 3:1

PIN	1	2	3	4	5	6	7	8	9	10	11	12	13	14	15	16
NAME	VSS	VDD	V0	RS	R/W	E	DB0	DB1	DB2	DB3	DB4	DB5	DB6	DB7	LED+	LED-

SPECIFICATIONS

1. DISPLAY TYPE: FSTN/TRANSMISSIVE/POSITIVE/B-W
2. LCD DRIVING VOLTAGE: 4.7V
3. LOGIC VOLTAGE: 5.0V
4. VIEWING DIRECTION: 12 O'CLOCK
5. OPERATING TEMP.: -10° C-60° C
6. STORAGE TEMP.: -20° C-70° C
7. DRIVE MODE: 1/16 DUTY, 1/5 BIAS
8. BACKLIGHT: WHITE/SIDE BACKLIGHT/5.0V
9. OTHER:

NOTE:

MECHANICAL TOL.±0.3 UNLESS SPECIFIED

DESCRIPTION:

C/D

SCALE: FIT
 SHEET: 1 OF 1

 TINSHARP INDUSTRIAL CO.,LTD.

UNIT:	PROJECTION	MODEL	SERIAL NUMBER
mm		TC1602A-66C	ZHJ0162
APP:		CHK:	DWN:
DATE:		DATE:	DATE:

VERSION	CHANGE CONTENT	DATE
V00	FIRST ISSUE	2015-03-23